

LVP615 serial quick user guide V1.0

In order to make sure users can quickly use LVP615 serial LED video processor, we prepared the <LVP615 serial quick user guide>. About LVP615 deeply setup, adjustment and operation, please refer to <LVP615 serial user manual>.

Front/rear panel button introduction

Front panel button

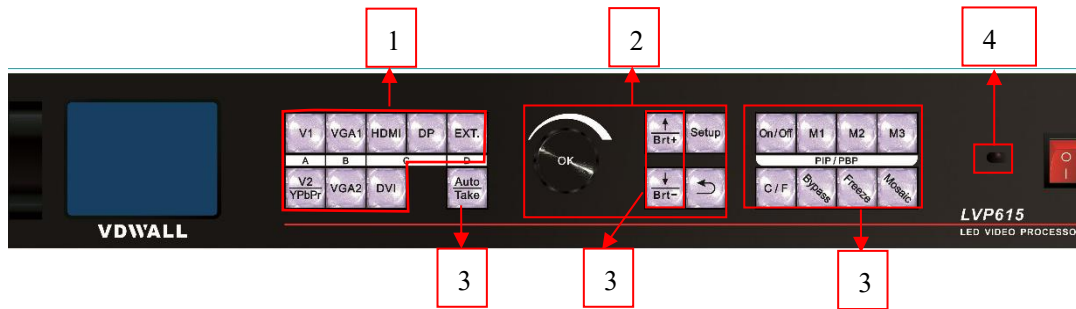

⊕ input signal selection keys : used to select corresponding input signals.			
V1 , V2/YPbPr , VGA1 , VGA2 , HDMI , DP , DVI , EXT.			
⊗ setup key : used to set LVP615 parameters			
Setup	Enter menu	knob	rotate knob can change current setup item parameters press knob (OK key)to save parameters.
↑ , ↓	Select setup items		
↶	Menu return key		
⊙ other function keys			
Auto	VGA auto adjustment	C/F	switching effect selection key
Take	Switch signals under Pre+Take switching mode	M1 , M2 , M3	PIP/PBP display mode key
Brt+ Brt-	Output brightness adjustment key	On/Off	PIP/PBP function on/off key
Bypass	Full and part display mode and switching key	Mosaic	Mosaic function on key
		Freeze	Output image freeze key
⊕ remote sensing window : built in infrared receiver			

Rear panel button

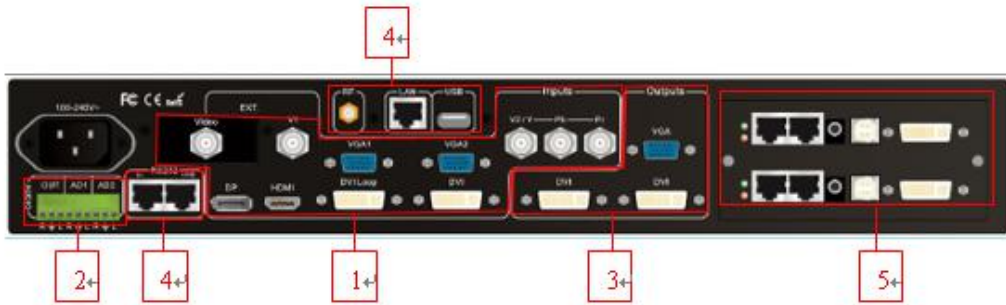

- 1) video signal input ports 2) audio signals input and output 3) video signal outputs 4) communication ports 5) sending card installation location

Step 1: sending card installation

- 1) Take out LVP615 processor, unscrew the sending card baffle screws and pull out the sending card tray.
- 2) Install the sending card on the corresponding location of sending card tray and tighten the screws.
- 3) Connect sending card +5 power cable and push the tray into the box.
- 4) Tighten the baffle screws. Then finish sending card installation.

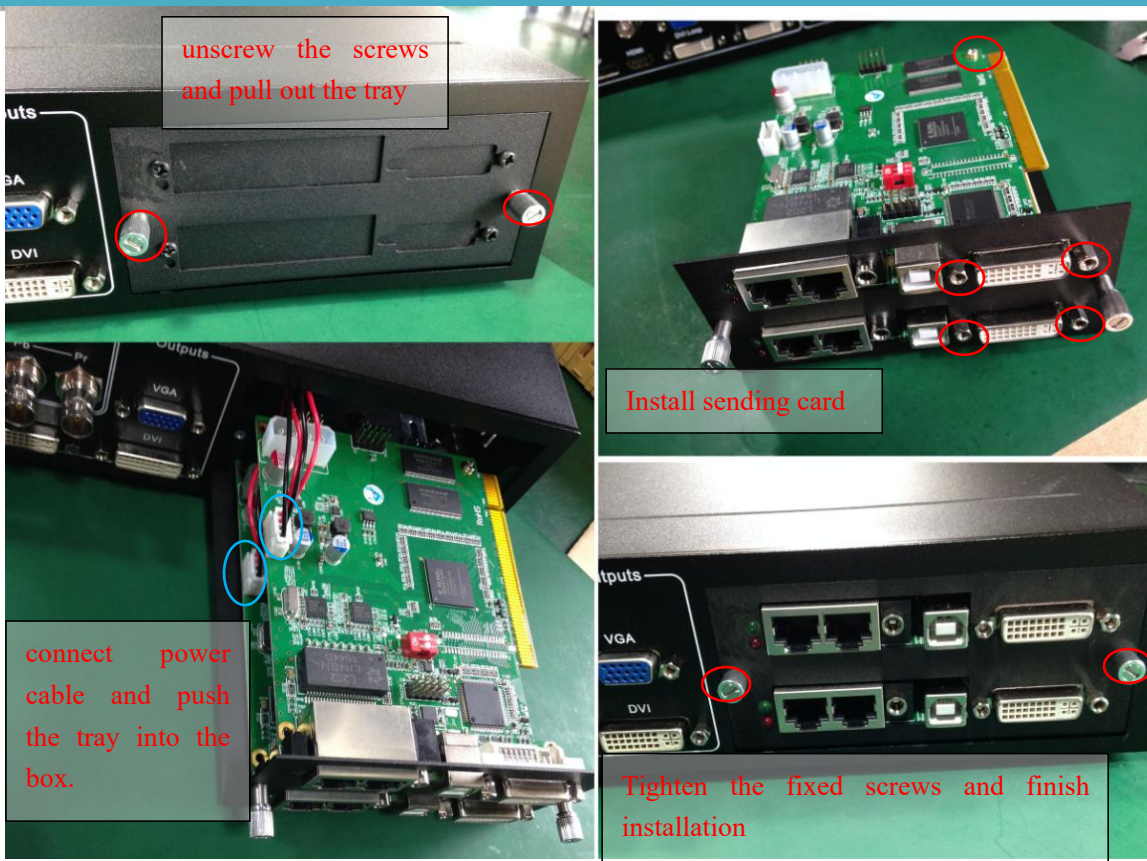

Step 2: connect input and output signals

- 1) Turn off the power of all signal source devices.
- 2) Connect the output signals from video sources to corresponding video input ports of LVP615.
- 3) Connect LVP615 DVI outputs to DVI inputs of sending cards.
- 4) Connect sending card RJ45 cables to LED receiving cards .
- 5) Connect LVP615 VGA output to LCD display(used as monitor).

Refer to follow connection diagram :

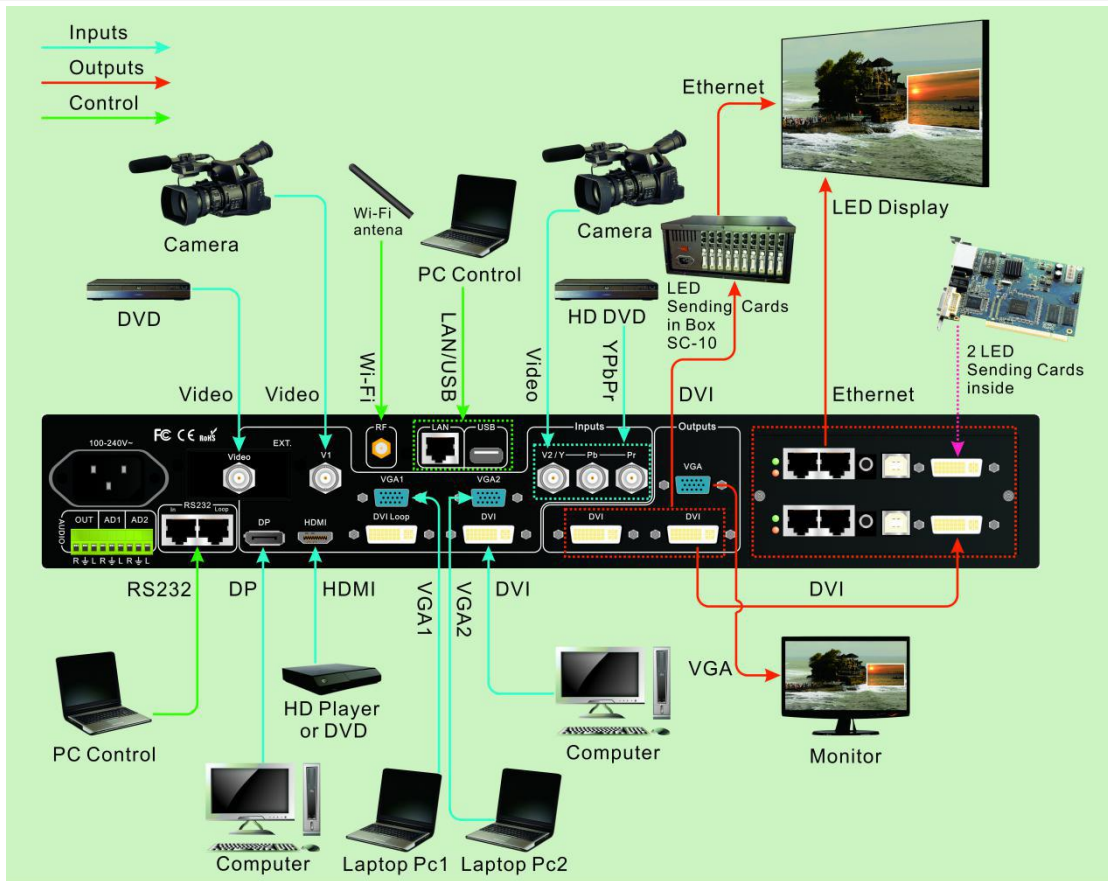

Connection diagram

Step 3: Connect power and power on

- 1) Make sure all input and output connection correct.
- 2) Connect power to LVP615 and turn on it.
- 3) Power on the video source devices.

Step 4: input signals selection



After turn on LVP615, LCD will show as below. Press input signal key to choose corresponding input signal.

```

Input:           HDMI
In status:      1080p_60Hz
-----
Output size:    1920x1080
Output start:   (0, 0)
-----
Switch mode:    one key SW
Switch time:    1.5sec
    
```



Step 5: output resolution setup

When turn on LVP615,

- 1) Press **Setup** key , then press knob (**OK**), LVP615 enter setup menu and press  to select corresponding setup menu. Press knob (**OK**) to enter. Press  back to last item. Rotate knob to select language “中文” or “English” and press **OK** to save.
- 2) Enter setup menu : 1.out image → 1.1 resolution , and rotate knob to change output resolution. Select output resolution which is bigger than LED real resolution and press **OK** to save.
- 3) Processor will restart automatically to apply for new output resolution.

Step 6: output image width and height setup

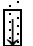
After LVP615 restart

- 1) Press **Setup** , then press **OK** to enter setup menu 1.out image → 1.2 out width , rotate knob to change the output width value to the actual pixel value of LED screen and press **OK** to save.
- 2) Then press  enter 1.3 out height , and rotate **OK** to change the output height value to the actual pixel value of LED screen. Press **OK** to save.
- 3) Press  to exit setup menu.

Step 7: computer resolution setup

- 1) Enter computer graphic card control interface, In setting up multiple monitors, select mode

“copy” “extend” or “dual display” .

- 2) Set the monitor resolution as the same of LVP615 output resolution. The LVP615 LCD will display current computer resolution.

Step 8: part / full display (Bypass)

- 1) Press DVI key to select DVI input signal. Make sure DVI input resolution is bigger than the LVP615 output width and height.
- 2) Press **Bypass** key and indicator on, LED screen is under part pixel to pixel display situation. Picture is not compressed.
- 3) Then press **Bypass** key and indicator off, LED screen is under full display situation. Picture is compressed to display whole on the LED screen.

Step 9: turn on PIP / PBP

- 1) In single picture display state, press signal key to select background signal.
- 2) Press **ON/OFF** key, LCD will show : PIP= ?
- 3) Select signal key to select PIP/PBP signal to enter dual pictures display.
- 4) LVP615 can presave 3 different kinds of PIP/PBP mode, Press mode key "**M1**~**M3**" to select.
- 5) Under PIP / PBP on state, Press **ON/OFF** key to turn off PIP/PBP function. LED screen will show single picture.

Step 10: setup PIP / PBP parameters

- 1) After turn on PIP/PBP, press **Setup** , then press **OK** , LVP615 enter PIP/PBP setup menu.

D. PIP/PBP	Mode=M1
D.1 PIP width	640
D.2 PIP height	320
D.3 PIP H_start	16
D.4 PIP V_start	16
D.5 Main width	1920
D.6 Main height	1080
D.7 Main H_start	0
D.8 Main V_start	0

2) Press **M1**~**M3** to select needed set mode, press **↑/↓** to select needed set items and rotate knob to change parameters. Press **OK** to save parameters and finish PIP/PBP setup.

Appendix: modify the record table

Version	Time	Description	Draft
V1.0	2017.5.9	the first release	Lts